

D型：拉杆、凸轮锁紧连接

Form D Mounting With Studs and Camlocks

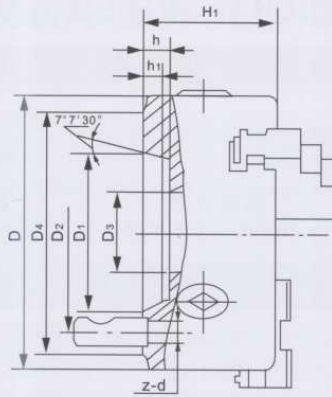
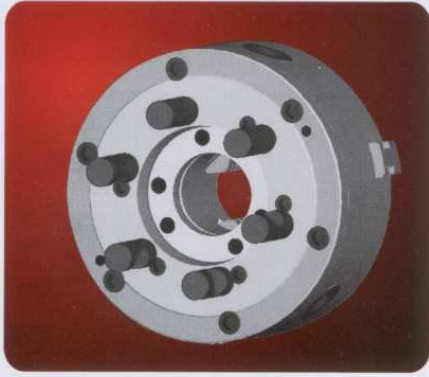

K11 SERIES DIRECT MOUNTING  
3-JAW SELF-CENTERING CHUCKS

K11□/□系列短锥三爪自定心卡盘

FUERDA

规格表 SPECIFICATIONS

单位/UNIT: mm

Code No.	D	D1	D2	D3	D4	H1	h	h1	z-d	净重Kg Net wt.
K11-125 /D3	125	53.975	70.6	25	92	63	13	10	3-M10 X 1	6
K11-125 /D4	125	63.513	82.6	25	117	63	13	10	3-M10 X 1	6
K11-160/D3 K11-160A/D3	160	53.975	70.6	40	92	76	13	10	3-M10 X 1	10
K11-160/D4 K11-160A/D4	160	63.513	82.6	40	117	70	13	10	3-M10 X 1	10
K11-160/D5 K11-160A/D5	160	82.563	104.8	40	146	73	15	12	6-M12 X 1	10
K11-200/D4 K11-200C/D4 K11-200A/D4	200	63.513	82.6	50	117	86	13	10	3-M10 X 1	17
K11-200/D5 K11-200C/D5 K11-200A/D5	200	82.563	104.8	50	146	86	15	12	6-M12 X 1	17
K11-200/D6 K11-200C/D6 K11-200A/D6	200	106.375	133.4	50	181	86	16	13	6-M16 X 1.5	17
K11-250/D5 K11-250C/D5 K11-250A/D5	250	82.563	104.8	70	146	95	15	12	6-M12 X 1	31
K11-250/D6 K11-250C/D6 K11-250A/D6	250	106.375	133.4	70	181	98	16	13	6-M16 X 1.5	32
K11-250/D8 K11-250C/D8 K11-250A/D8	250	139.719	171.4	80	225	98	18	14	6-M20 X 1.5	32
K11-315/D6 K11-315C/D6 K11-315A/D6	315	106.375	133.4	100	181	103.5	16	13	6-M16 X 1.5	49
K11-315/D8 K11-315C/D8 K11-315A/D8	315	139.719	171.4	100	225	103.5	18	14	6-M20 X 1.5	49
K11-315/D11 K11-315C/D11 K11-315A/D11	315	196.869	235	100	298	103.5	20	16	6-M22 X 1.5	51
K11-320/D6 K11-320C/D6 K11-320A/D6	320	106.375	133.4	100	181	103.5	16	13	6-M16 X 1.5	50
K11-320/D8 K11-320C/D8 K11-320A/D8	320	139.719	171.4	100	225	103.5	18	14	6-M20 X 1.5	50
K11-320/D11 K11-320C/D11 K11-320A/D11	320	196.869	235	100	298	103.5	20	16	6-M22 X 1.5	52
K11-325/D6 K11-325C/D6 K11-325A/D6	325	106.375	133.4	100	181	103.5	16	13	6-M16 X 1.5	51
K11-325/D8 K11-325C/D8 K11-325A/D8	325	139.719	171.4	100	225	103.5	18	14	6-M20 X 1.5	51
K11-325/D11 K11-325C/D11 K11-325A/D11	325	196.869	235	100	298	103.5	20	16	6-M22 X 1.5	53
K11-380/D8 K11-380C/D8 K11-380A/D8	380	139.719	171.4	130	225	118	18	14	6-M20 X 1.5	81
K11-380/D11 K11-380C/D11 K11-380A/D11	380	196.869	235	135	298	118	20	16	6-M22 X 1.5	81
K11-400/D8 K11-400C/D8 K11-400A/D8	400	139.719	171.4	130	225	118	18	14	6-M20 X 1.5	85
K11-400/D11 K11-400C/D11 K11-400A/D11	400	196.869	235	135	298	118	20	16	6-M22 X 1.5	85
K11-500/D11 K11-500A/D11	500	196.869	235	190	298	135	20	16	6-M22 X 1.5	159
K11-500/D15 K11-500A/D15	500	285.775	330.2	210	403	135	21	17	6-M24 X 1.5	159
K11-630/D11 K11-630A/D11	630	196.869	235	252	298	155	20	16	6-M22 X 1.5	250
K11-630/D15 K11-630A/D15	630	285.775	330.2	252	403	155	21	17	6-M24 X 1.5	250